



HIT SPORT

MCS020

PORTABLE BASKETBALL HOOP MANUAL



SAFETY INSTRUCTIONS

Do not stand the basketball hoop upright until the base is filled with water or sand, as system may tip over causing injuries.

Do not use system during windy and/or severe weather conditions the basketball hoop is easy to tip over, please move the system indoors.

Must tip the system for ward and rest the rim on as urface before adjusting the height.

- Owner must ensure that all players know and follow these rules for safe operation of the system.
- Check entire box and inside all packing material for parts and additional instruction material.
- Before beginning assembly, read the instructions and identify parts according to this manual.
- Proper and complete assembly, use, and supervision are essential for proper operation and to reduce the risk of accident or injury.
- A high probability of serious injury exists if this system is not installed, maintained, and operated properly.

- Two capable adults are recommended for this operation.
- Check base regularly for leakage. Slow leaks could cause system to tip over unexpectedly.
- Seat the pole sections properly(if applicable). Failure to do so could allow the pole sections to separate during play and transport of the system.
- Climate, corrosion, or misuse could result in system failure.
- This equipment is intended for home recreational use only and not excessive competitive play.
- The life of your basketball pole depends on many conditions. The climate, placement of the pole, Location of the pole, exposure to corrosives such as pesticides, herbicides, or salts are all important.
- If technical assistance is required, contact Customer Service.

Most injuries are caused by misuse and not following instructions. Use caution when using this system.

GET TO KNOW THE BASIC PARTS

BACKBOARD

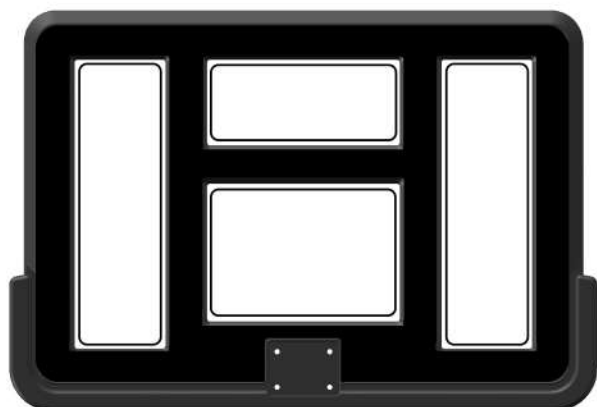

1



2



3

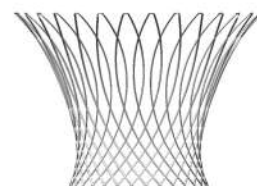

4

BASE



5



6



8



7

SUPPORT POLE



W



X



Y

GET TO KNOW THE BASIC PARTS

TOP SUPPORT POLE

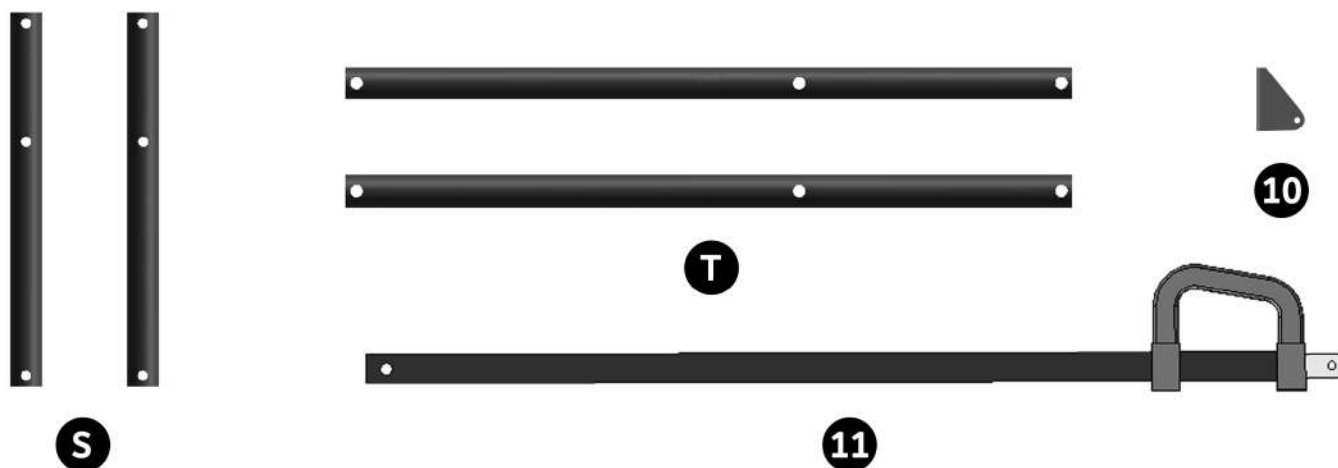

SPARE PARTS

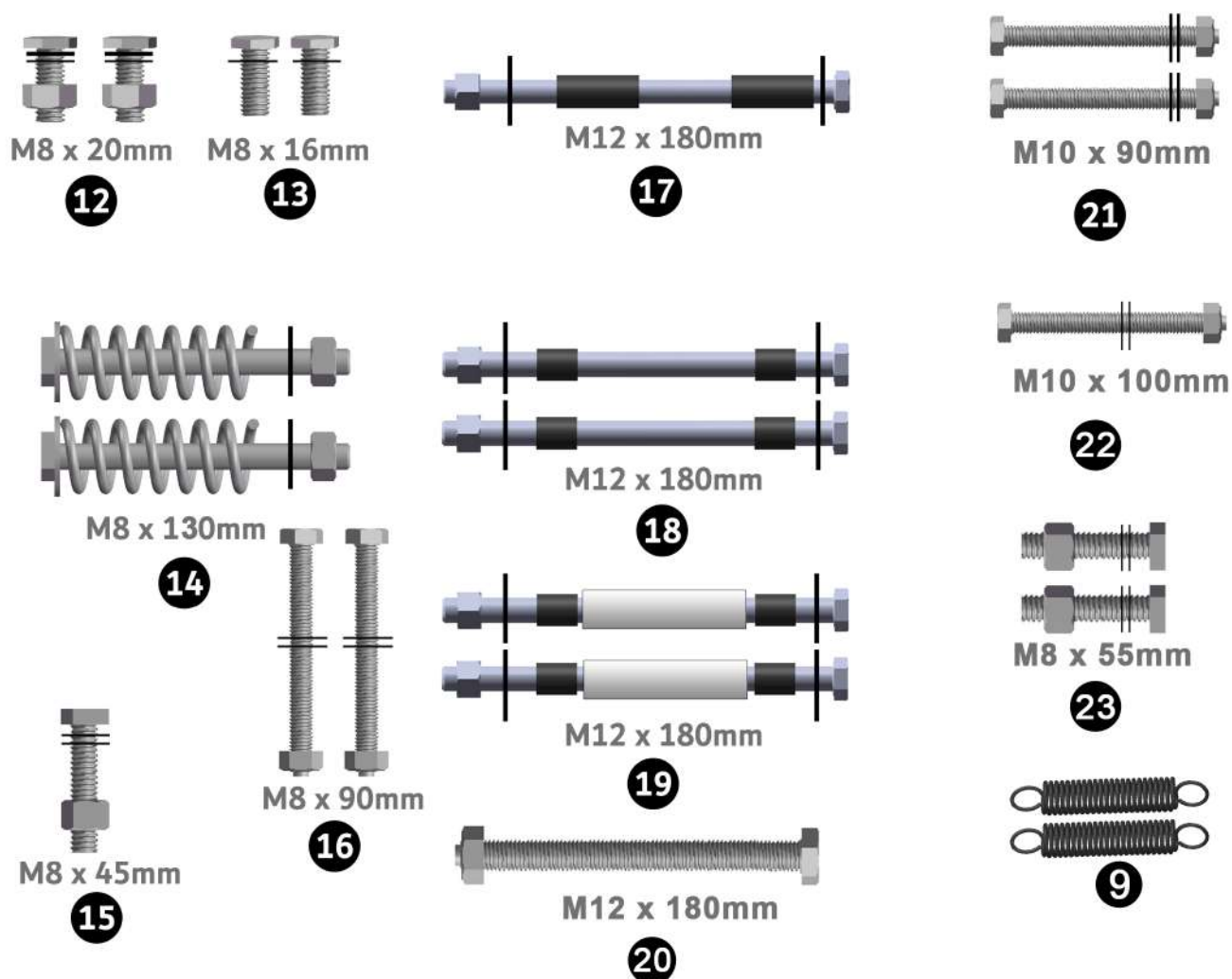

INSTALLATION STEPS

BASE

Needed Parts

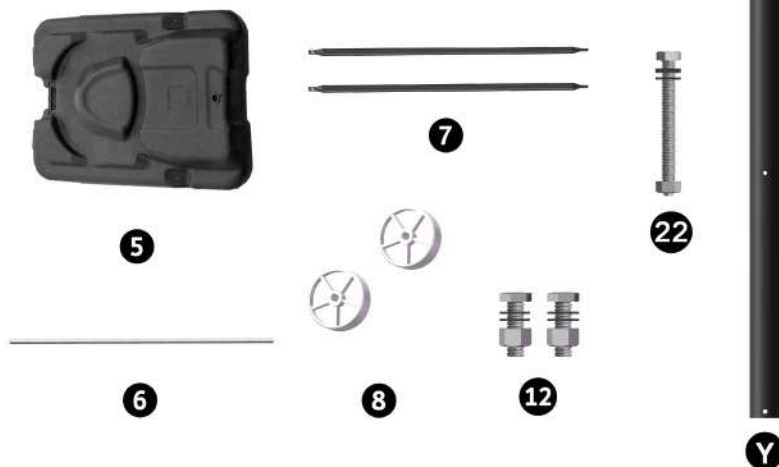

1.1

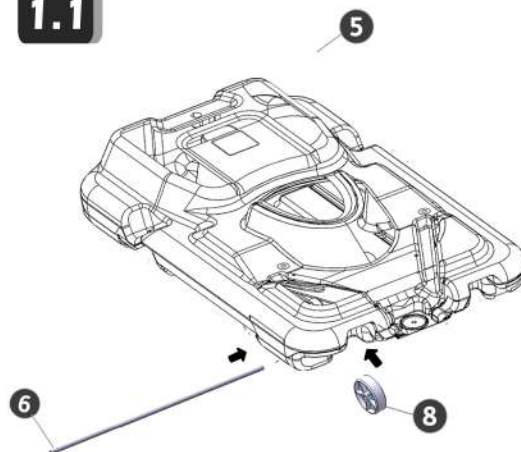

1.2

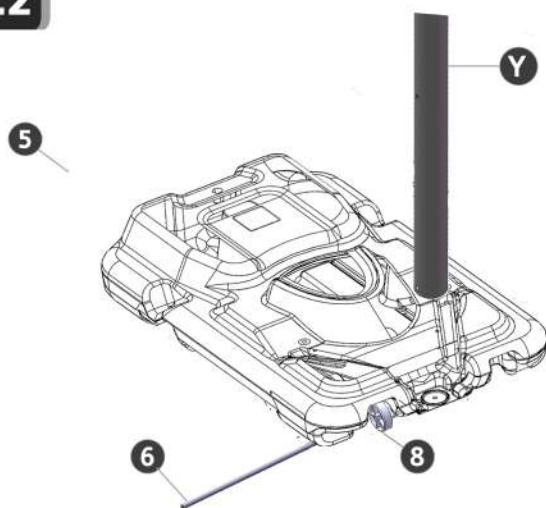

1.3

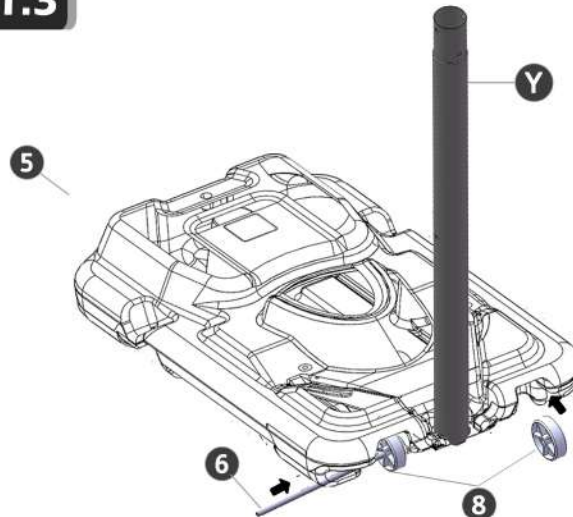

1.4

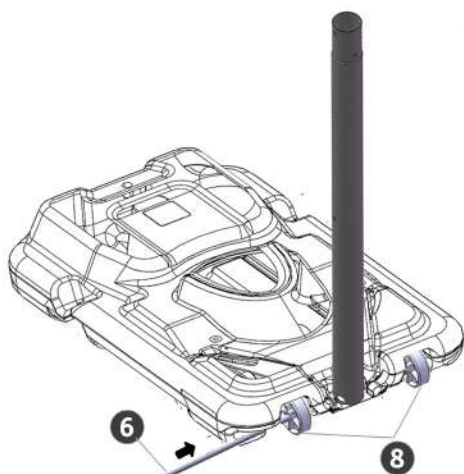

1.5

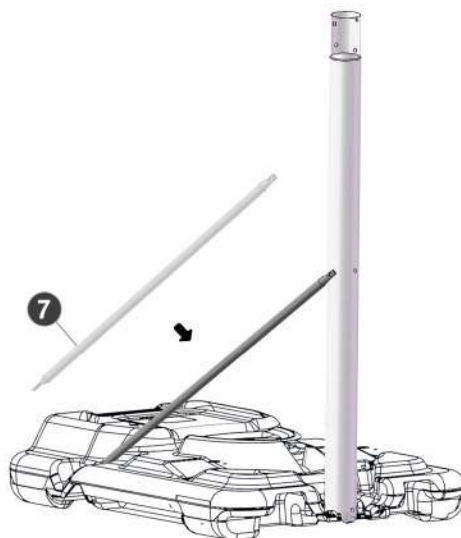

INSTALLATION STEPS

BASE

1.6

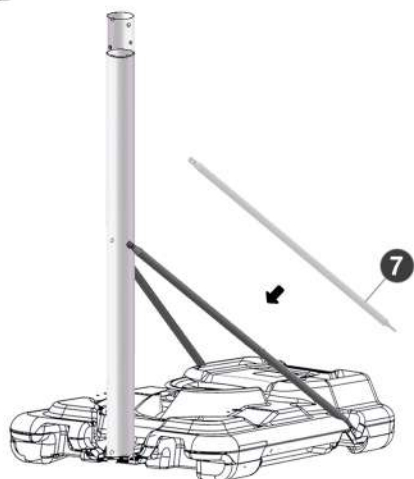

1.7

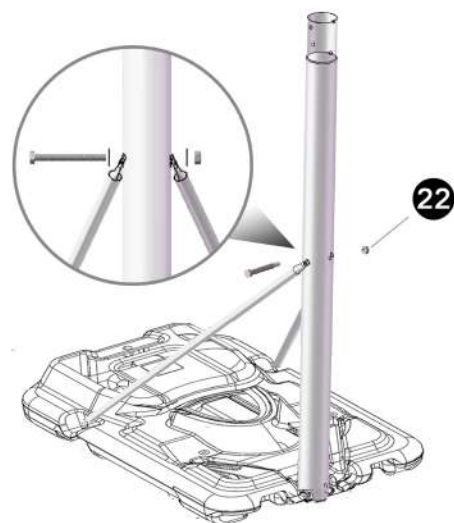

1.8

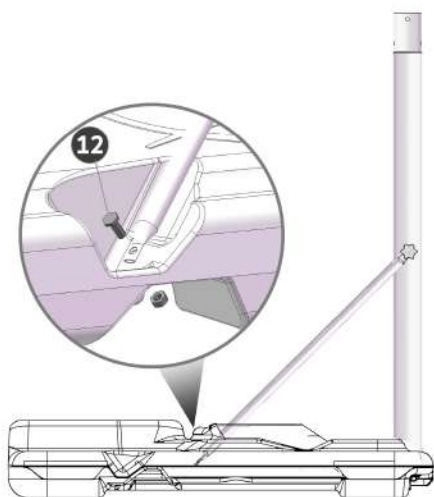

1.9

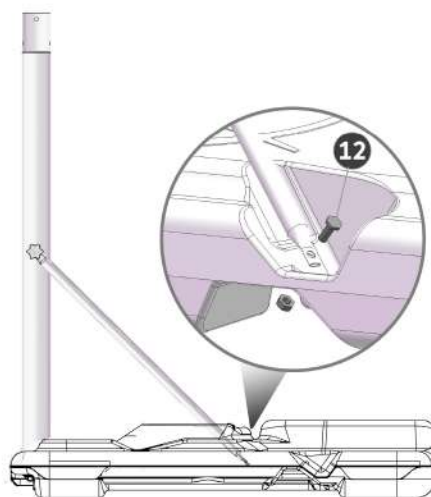

INSTALLATION STEPS

BACKBOARD

Needed Parts

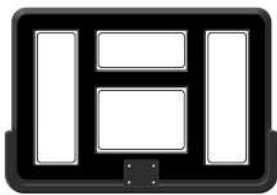

1



2



3

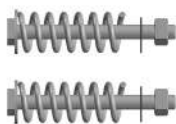

14



13



23



9

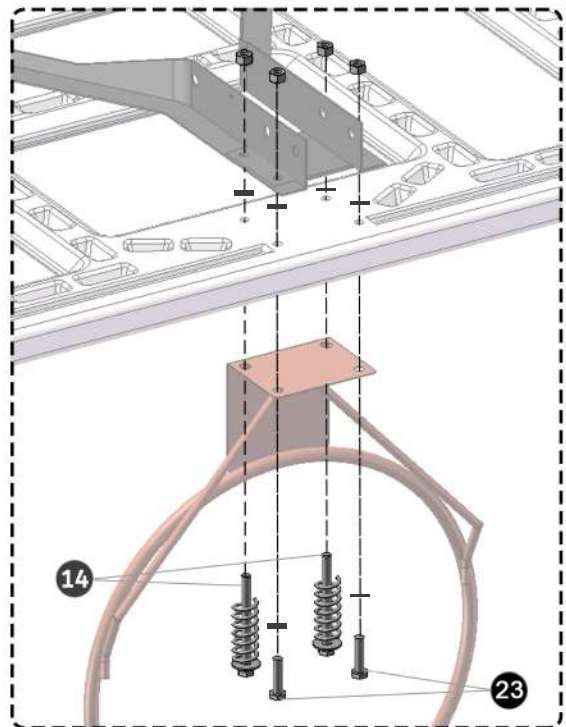

2.1

NOTE:

Please bend the #2 into a Y shape before installation

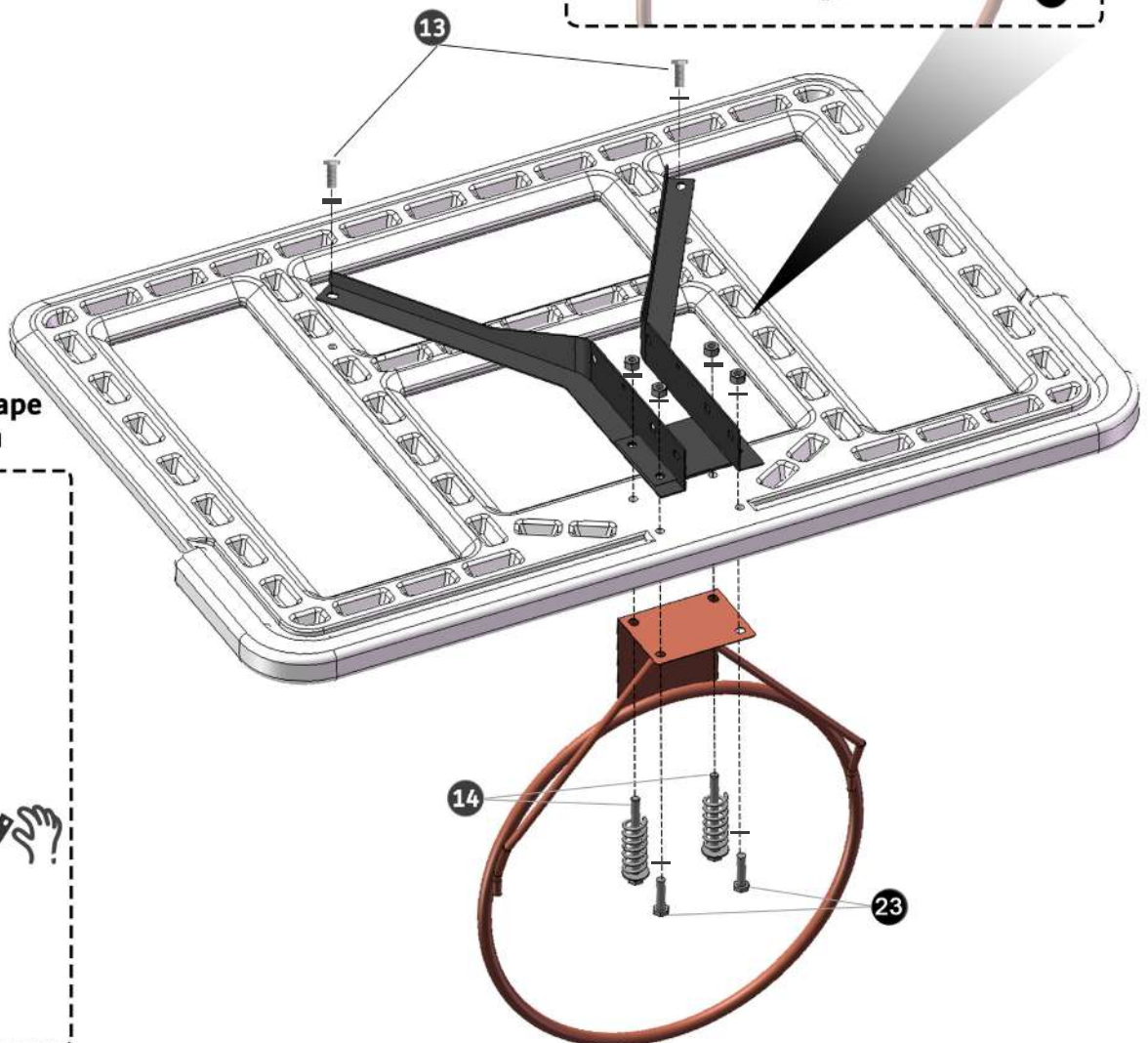
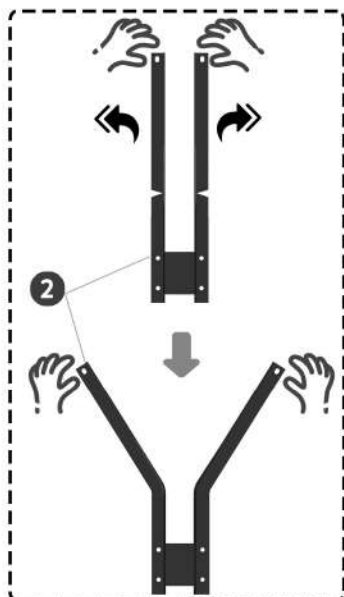

INSTALLATION STEPS

BACKBOARD

2.2

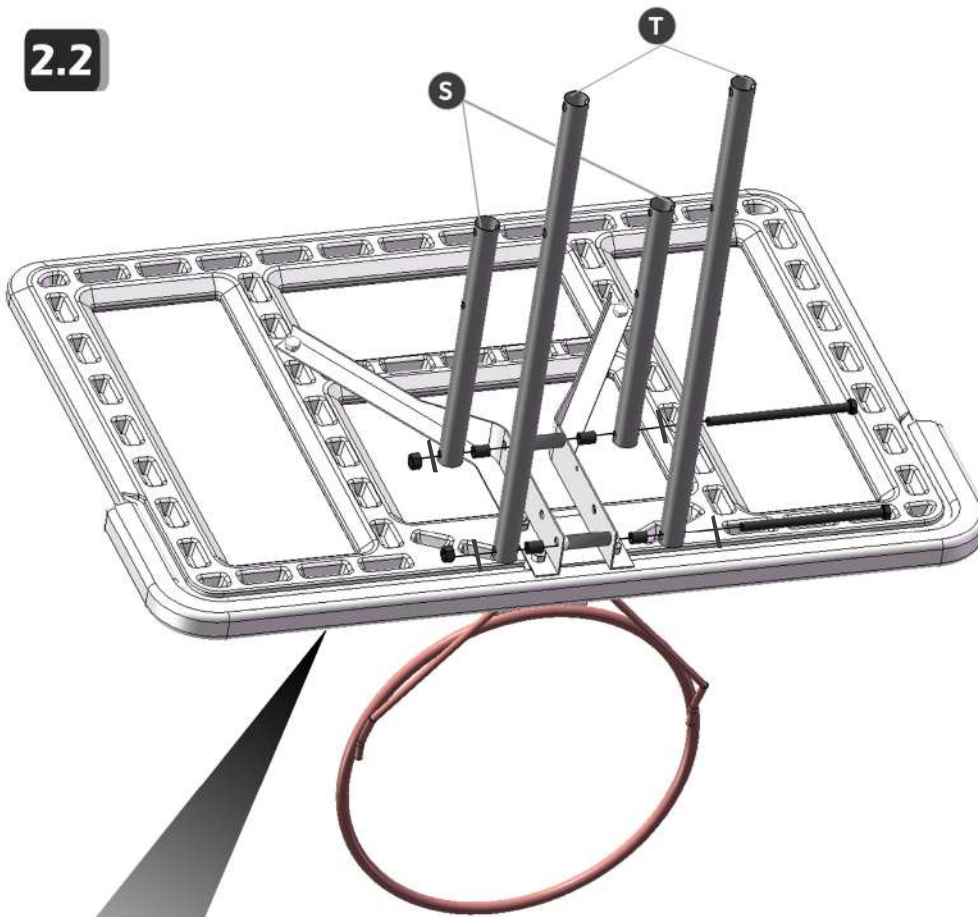

Needed Parts

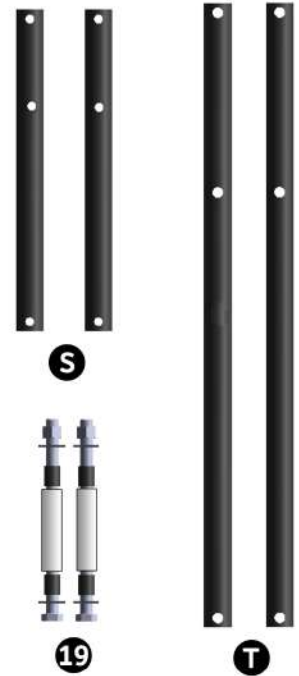

The longer length of S and T face to the backboard

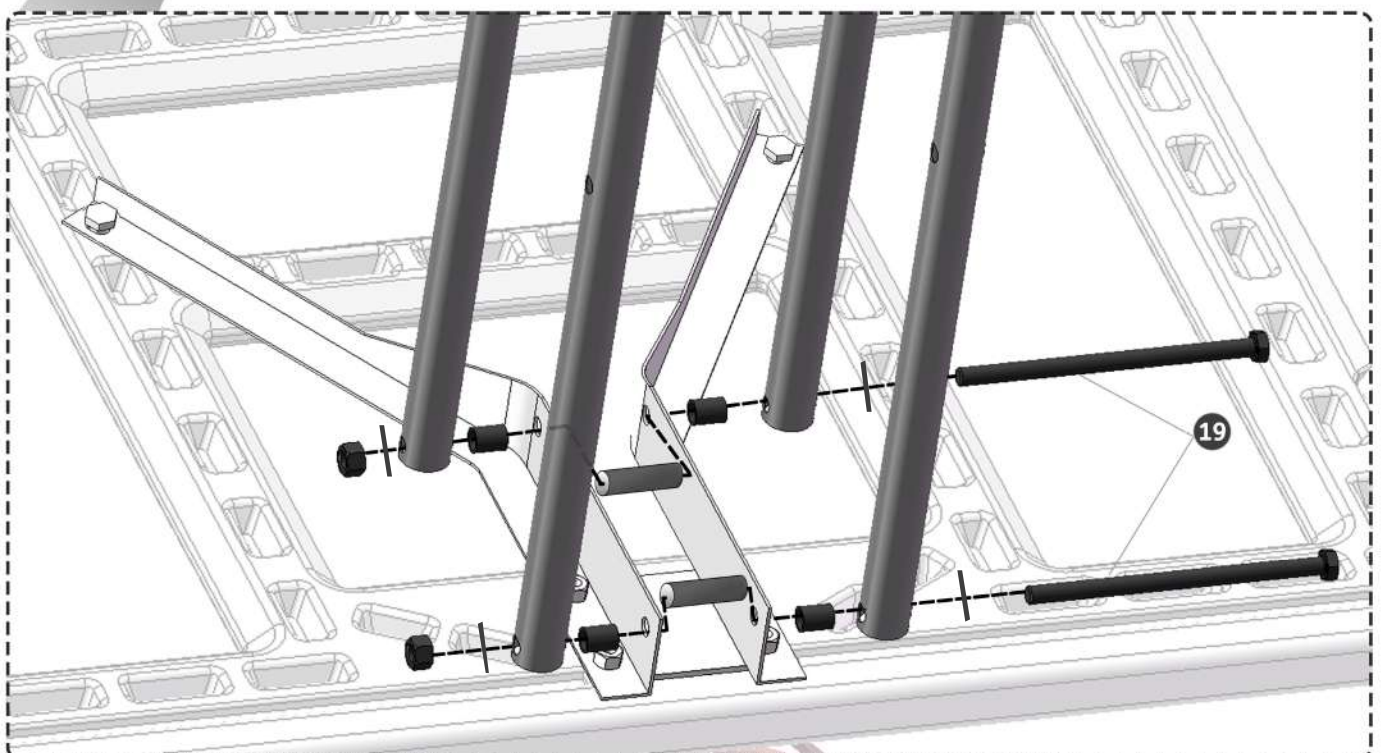

INSTALLATION STEPS

BACKBOARD

2.3

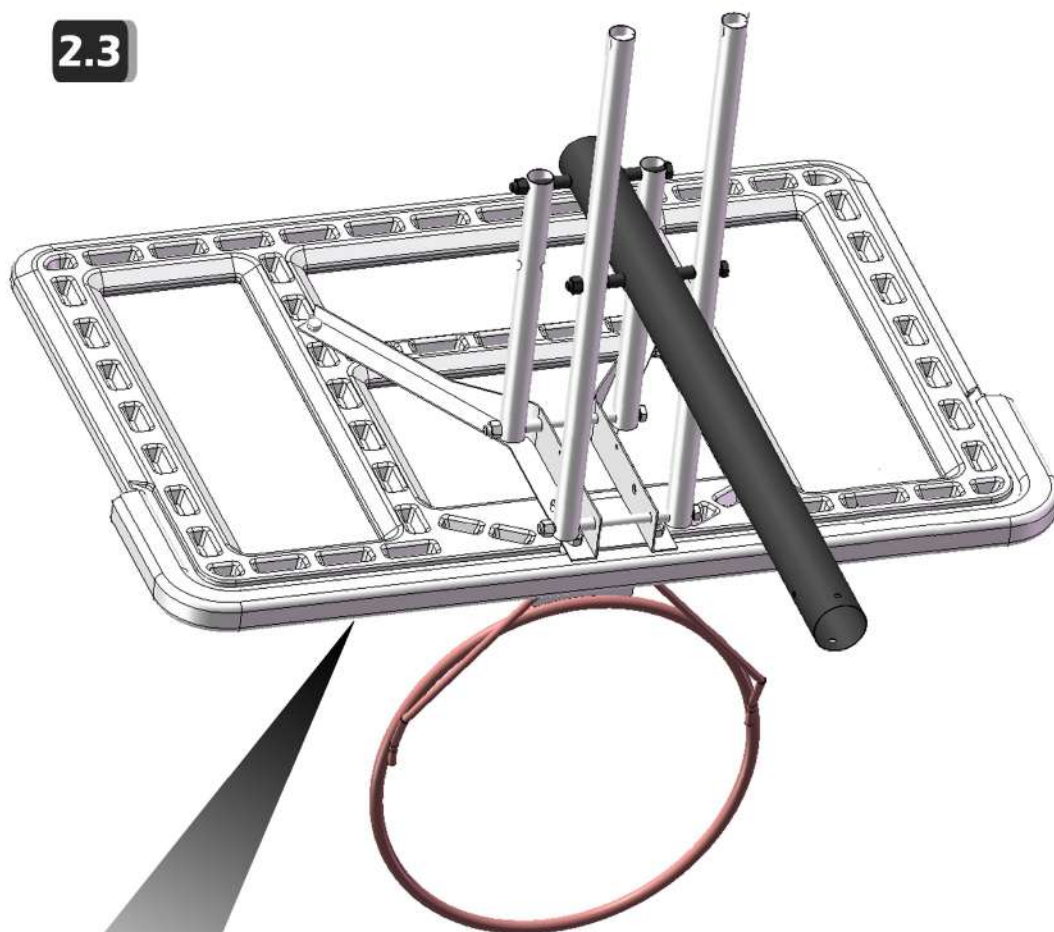

Needed Parts



18



W

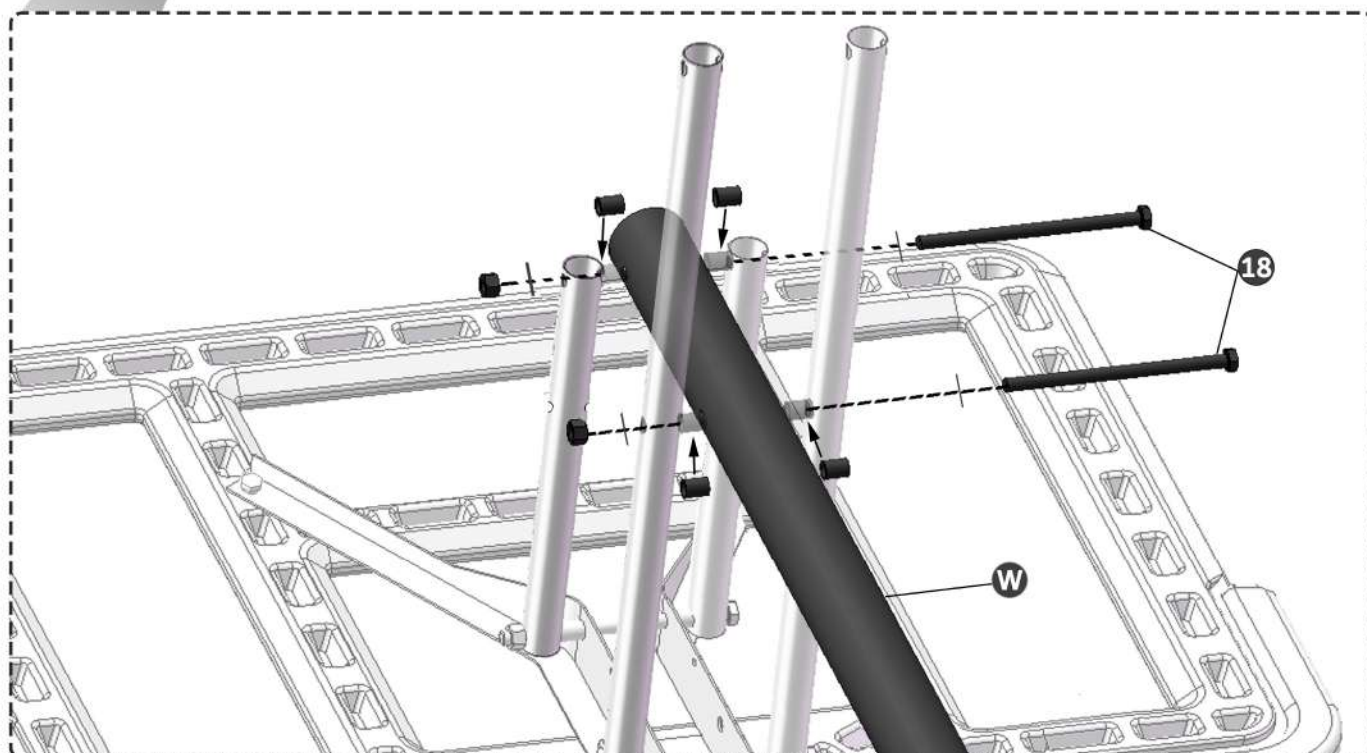

INSTALLATION STEPS

BACKBOARD

2.4

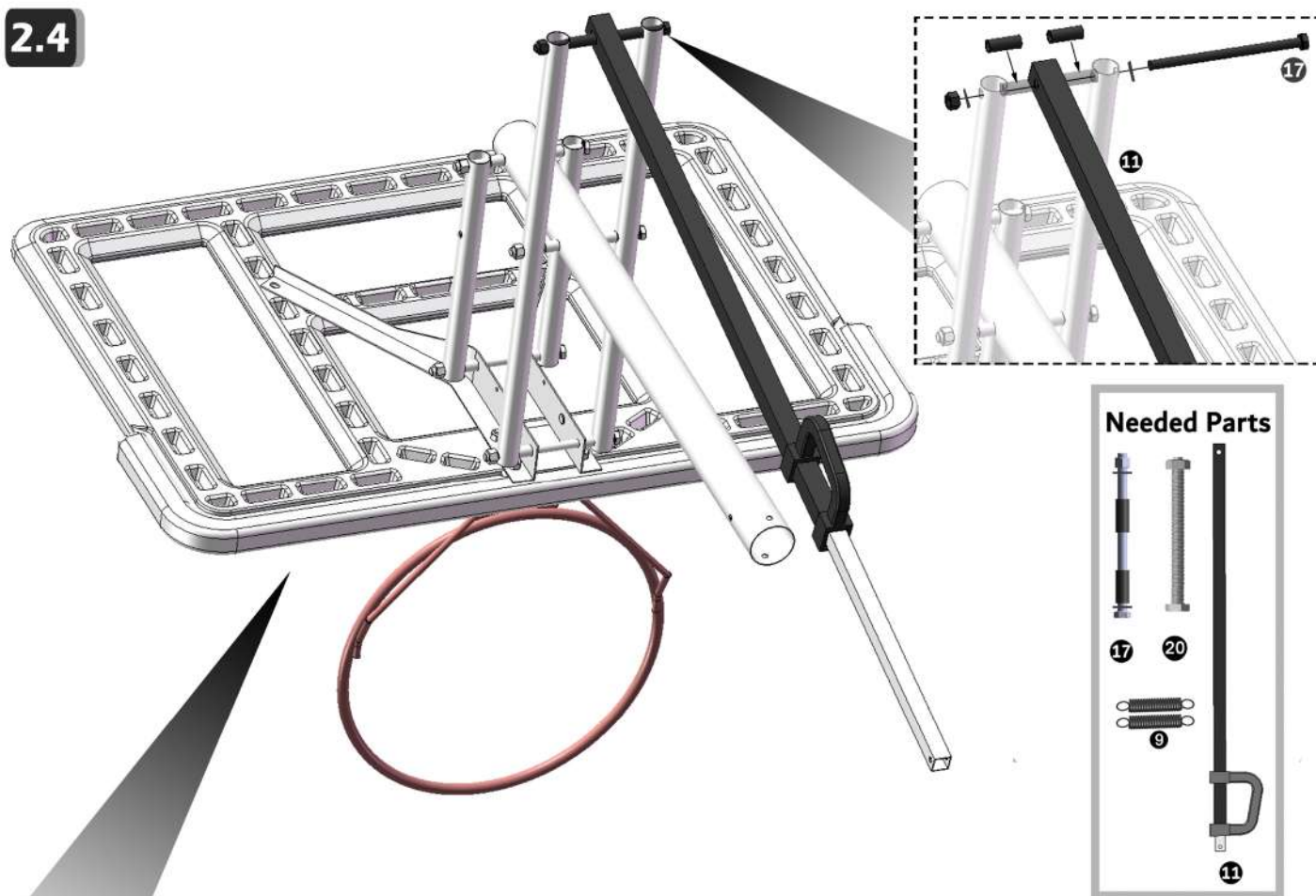

The spring (9) hang on the bolts(20) and the hole of (2)

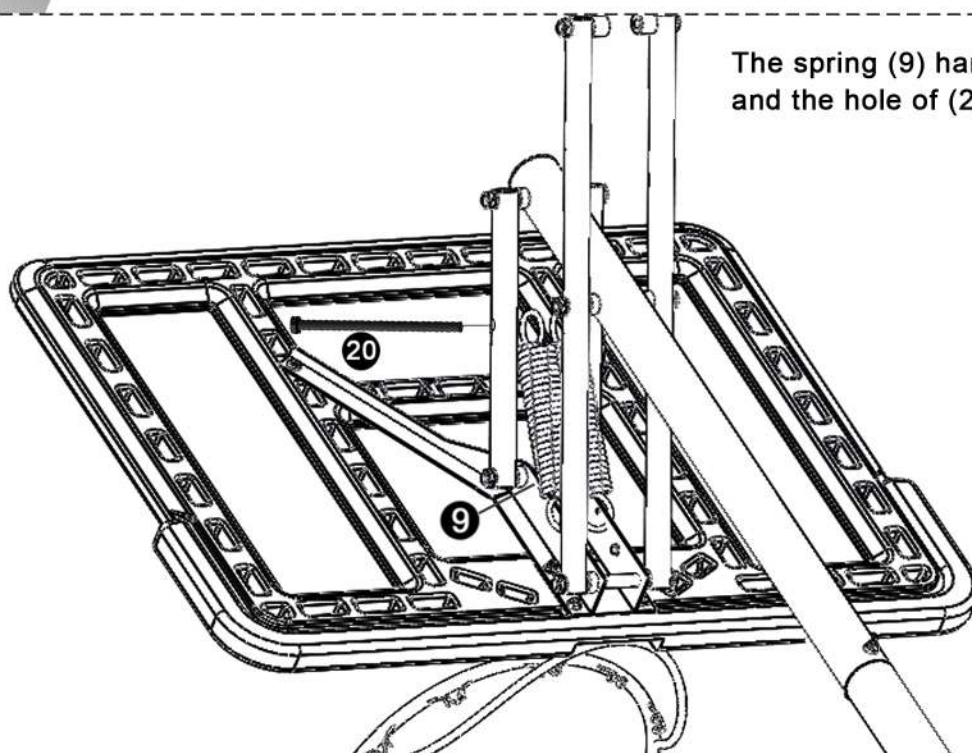

INSTALLATION STEPS

BACKBOARD

2.5

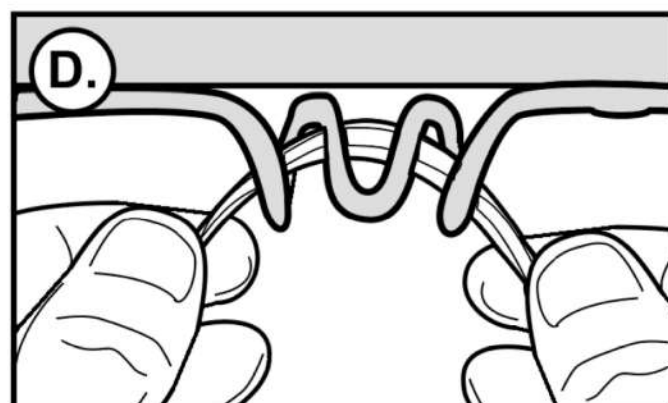
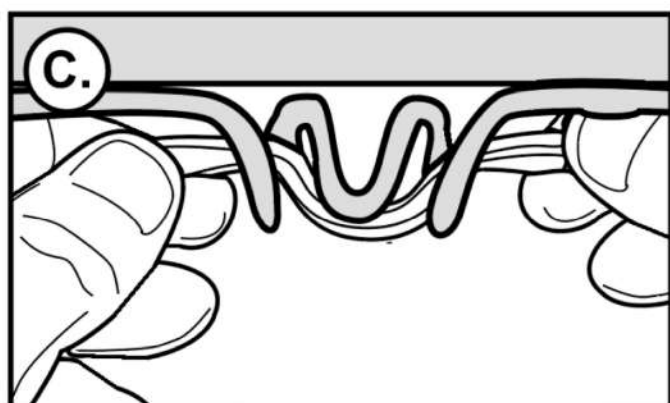
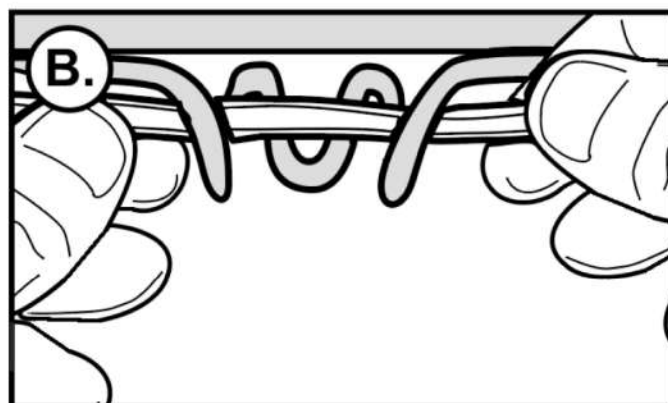
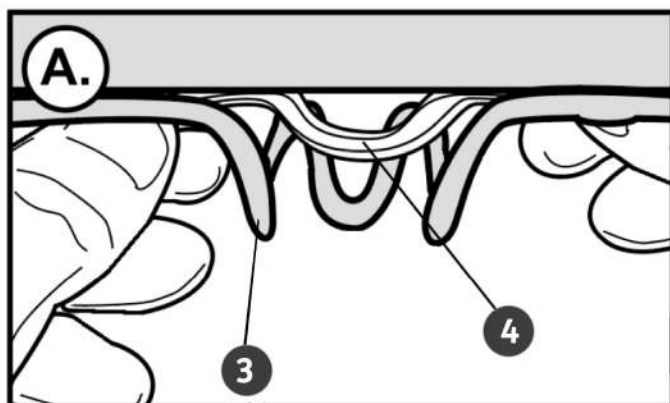

INSTALLATION STEPS

FINAL INSTALLATION

